

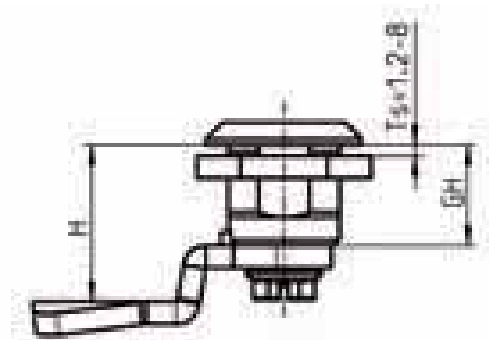

Cams



1. It is the wide variety of cams that makes the quarter turn and associated handles so flexible.
2. It is the lowly cam that makes the Swinghandle so versatile: 1, 2 and 3-point latching
3. Cams are simple, but there are subtleties that are not easily discernable from the catalog.
4. Most important – cams are not adjustable.



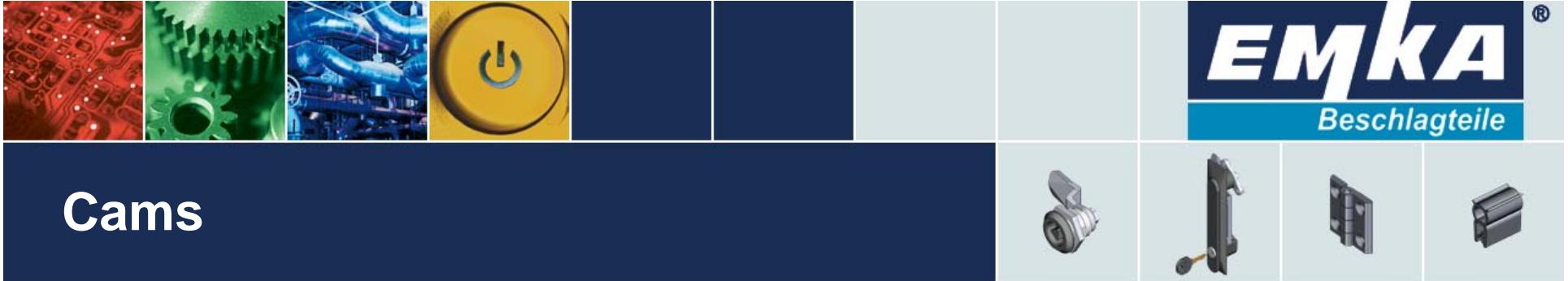

Cams are not adjustable

This means that no time consuming and error fraught positioning is needed or allowed. Therefore no inspection is needed. An immediate quality plus and cost reducer.

Select the correct part and the correct gasket compression is automatic.

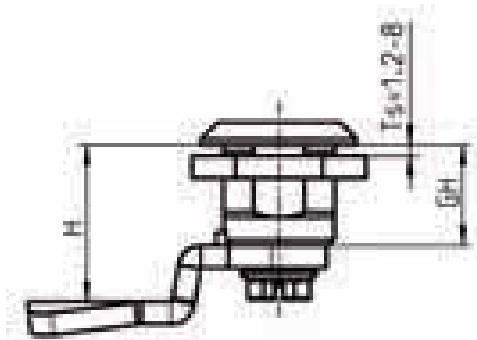



Standard Single Point Cams

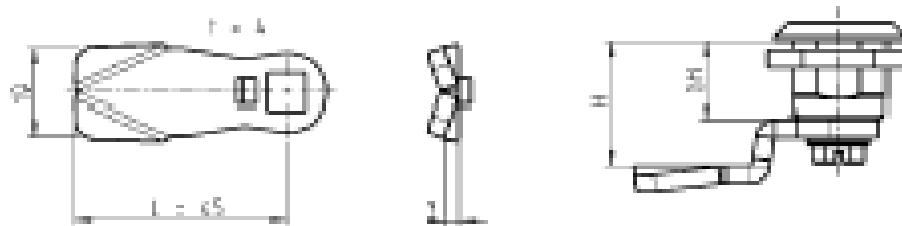

- All items shown in catalog except for some “duck-billed” type are stock, including Stainless, and 35mm long steel cams.
- All “catalog” single point cams have stops.
- Standard cams give a range of grip range, “H” from 4 to 50mm with standard housings, up to 92mm with extended housings
- GR Nylon cams are 35 mm long, also in stock.
- Design allows installation of fully assembled latch. (except where “H” < 6mm)



Selection of Cams

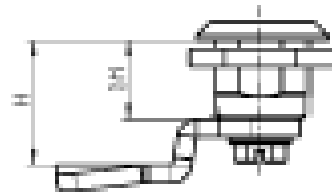

- The “OFFSET” of cams ($H - GH$) is not shown in the EMKA catalog. This offset can be positive or negative.
- What is shown is the resultant “H” dimension for various latch lengths “GH”
- So on pages such as 1C-120, -130, -140 there is a matrix for each standard cam and standard latch lengths (“GHs”).



Selection of Cams



H (GH=18)	P/N	Offset (mm)	H (GH=18)	P/N	Offset (mm)
4.....	1000-112	-14	30.....	1000-28	+12
6.....	1000-22	-12	32.....	1000-26	+14
8.....	1000-113	-10	34.....	1000-12	+16
10.....	1000-21	-8	35.....	1000-11	+17
13.....	1000-20	-5	36.....	1000-51	+18
14.....	1000-19	-4	38.....	1000-52	+20
16.....	1000-18	-2	40.....	1000-25	+22
18.....	1000-17	0	42.....	1000-53	+24
20.....	1000-16	+2	44.....	1000-54	+26
22.....	1000-15	+4	45.....	1000-10	+27
24.....	1000-14	+6	47.....	1000-55	+29
25.....	1000-27	+7	50.....	1000-56	+32
26.....	1000-50	+8			
28.....	1000-13	+10			

Standard cam offsets

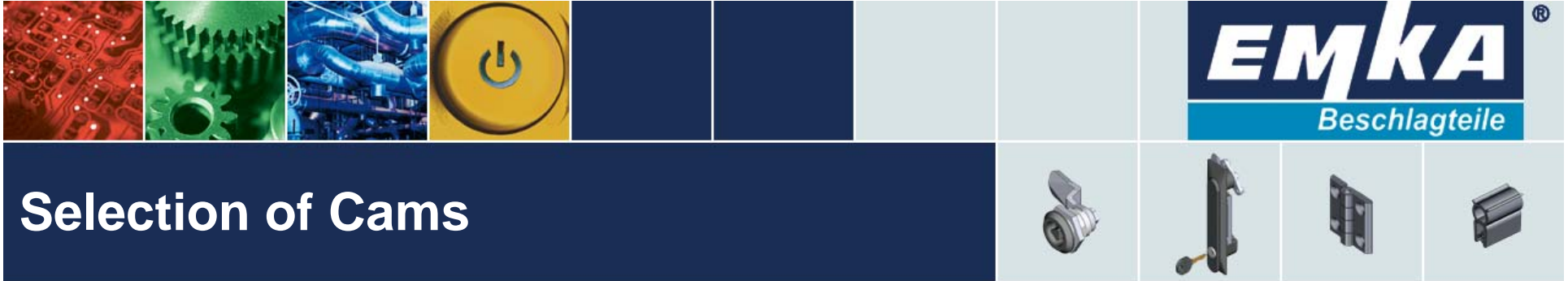

Selection of Cams

Where to Find Them

- Most cams are found on 1C-120, through 1C-160,
- Short steel and Polyamide cams are on page 1C-140
- 3-pt Stainless cams are on Page 8A-320
- 3-pt cams without stops are on page 3YB-420
- Cam adapters 1 to 3-pt are on pages 1C-220, 8A-580, 8A-340, 3YB-420
- “Adjustable” cams for compression latches are on Page 1C-137



“Duck-billed” Cams

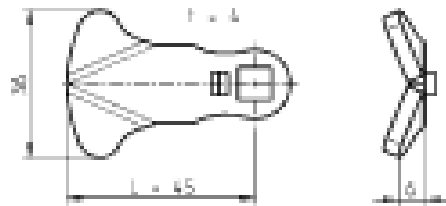

- This style gives 6 mm gasket compression, 3mm more than standard.
- Cannot install assembled latch unlike standard cams.
- “H” = 10, 18, 20, 28, 38 typically in stock – others require MOQ
- Inexpensive alternative to compression latch.



3-Point Cams



Standard 1000 series has rivets and circlips suitable for round rods, these and 1107 cams move rods 18mm.



1107 series cams are similar to above except: they have no stop and the rivets are positioned so the rod ends are 4mm further away from the door. When used with some Swinghandles this allows standard rods to clear the bottom part of the handle.

Two point versions of both these are available where no central latching point is needed



3-Point Cams



The 1000-U661-XX & -U662-XX 3-point cams

“H” = 25 & 38 in stock – most others: 2,000 MOQ

- Cannot use with rod adapter.
- 26 mm stroke – OK for 25 mm rollers
- Different cams for LH & RH doors
- No stop
- Less side to side movement
- Rods are offset from the latch centerline



1000-U663 2-point cam

- As above, but the same cam OK for LH & RH doors

These cams are designed for round rods, similar cams for flat rods, 1000-U544 and –U545, are functionally identical.



3-Point Cams (cont.)



Standard cams plus an adapter (1000-U776) perform exactly as the above cams and are less expensive.



1000-U776

The 1107-U246 is similar but it increases the “H” dimension of the cam by 2mm and effectively removes the stop also the rod ends are raised by 4mm Vs 2.5mm for the 1000-U776

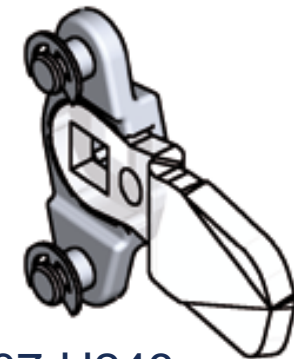

1107-U246

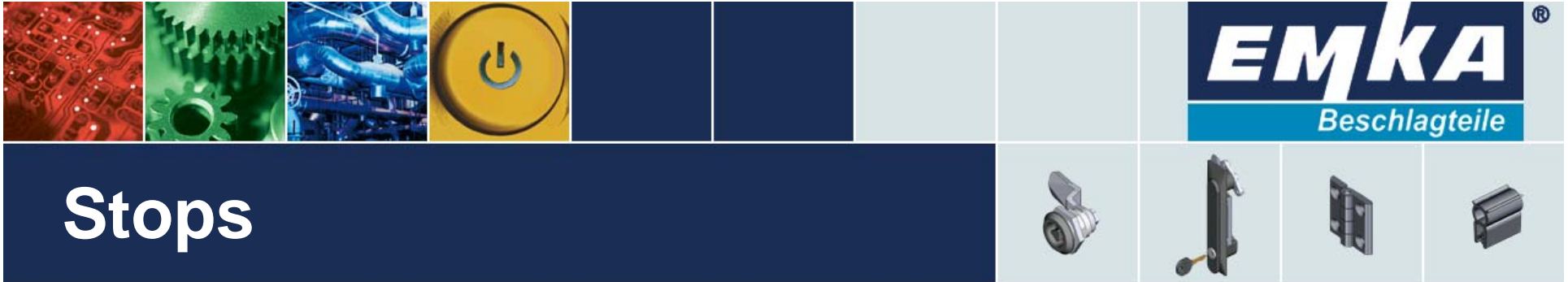

Stops prevent a quarter turn for turning more than 90°

- Cams with stops cannot be used on, 1000-U770, 1155, 1151 and original style 1150 type handles, poly cam stops must be removed on 1150 Unitech handles also.
- Cams can be made without stops (typically there is a set up charge but no MOQ) or these can be removed.
- Some stop-less single point cams are stock items
- For 3-point applications we can use 1107 or 1000-U661/2-XX. and 1000-U544/5 type cams. (MOQs do not apply to any 1107 cams.)

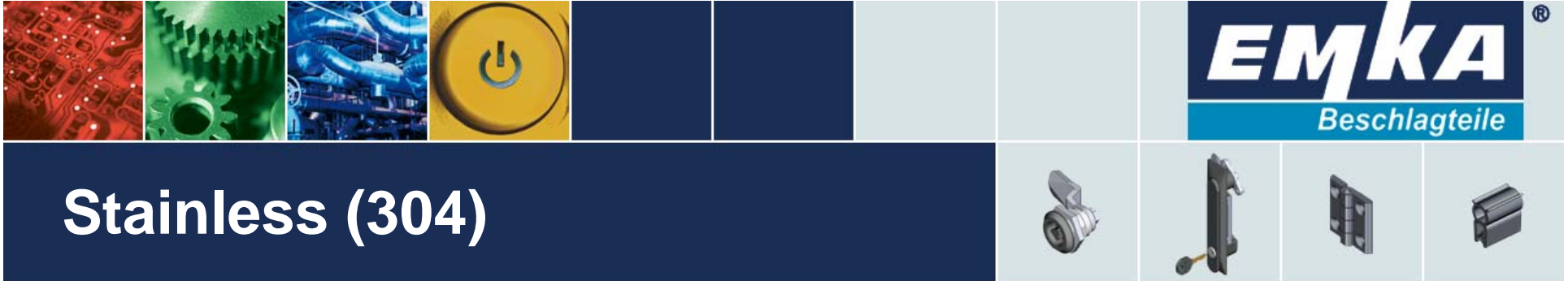

Stainless (304)

All the sizes, both single and 3-pt in the catalog are stock.

- If corrosion resistance is required consider nylon cams
- List of stock items is on 8A-320.
- The extra strength is a real plus for explosion proof or seismic cabinets.
- If corrosion resistance is required, a nickel/chrome plating might avoid tooling costs and reduce part price.
- The cam is inside the enclosure so is not subject to the same level of corrosive conditions as the outside of the box.



Specials – Tooling Available

Many cams in the catalog are non-stock items, for example some from these groups: 1000-U544/5; 1000-U661/2; 1000-XXX

- We may have some in stock, but our next production batch may need to meet the 2,000 minimum.
- We currently have 27 special cams in stock here.
- Single point specials, many no longer have an MOQ, but have a setup charge for fewer than 2,000
- We have tooling for “L” dimensions of 12 – 75mm & “H of 2 – 62mm, consult EMKA for specifics
- New tooling is needed for stainless specials even if we have tooling for the required size in mild steel



Cams



**Hooked cams, 3 styles,
One with a stop**





Slam Cams



Converts a locking or non-locking latch into a slam latch.

LH and RH versions

Not NEMA 4

Available in stainless

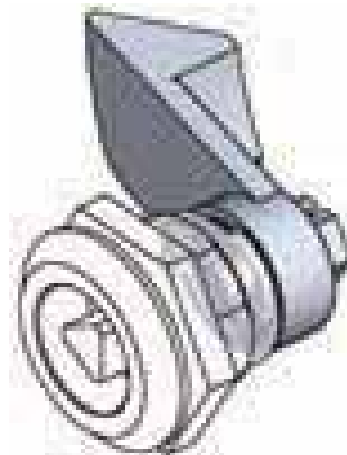

Cams

If the desired “H” dimension is not available consider an extended housing

The 3 cams for adjustable compression latches are straight, offset $\pm 14\text{mm}$ and offset $\pm 26\text{mm}$, they have no stops and no 3mm “lead.” See Page 1C-137

[http://www.emka.com/no_cache/us_en/products/details/catalog/quarter-turns-4/accessories-5/compression-latch-7.html?tx_ritemkacatalog_pi1\[showSpecial\]=PDFPreview](http://www.emka.com/no_cache/us_en/products/details/catalog/quarter-turns-4/accessories-5/compression-latch-7.html?tx_ritemkacatalog_pi1[showSpecial]=PDFPreview)



A stepped cam functions much as a compression latch



Cams



Stainless Steel Adapters

1000-U776-PH

1107-U246-PH

and

1150-U57



Maintains stop
and "H" dimension

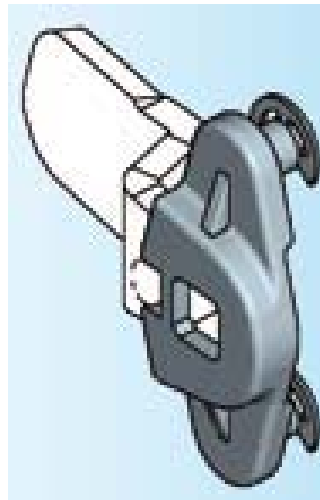

Recalculate
"H" dimension



Cannot use with
rod adapters